



DEVELOPMENT LAND EAST END

East End, East End & Colliers, Cayman Islands

MLS# 417049

CI\$350,000

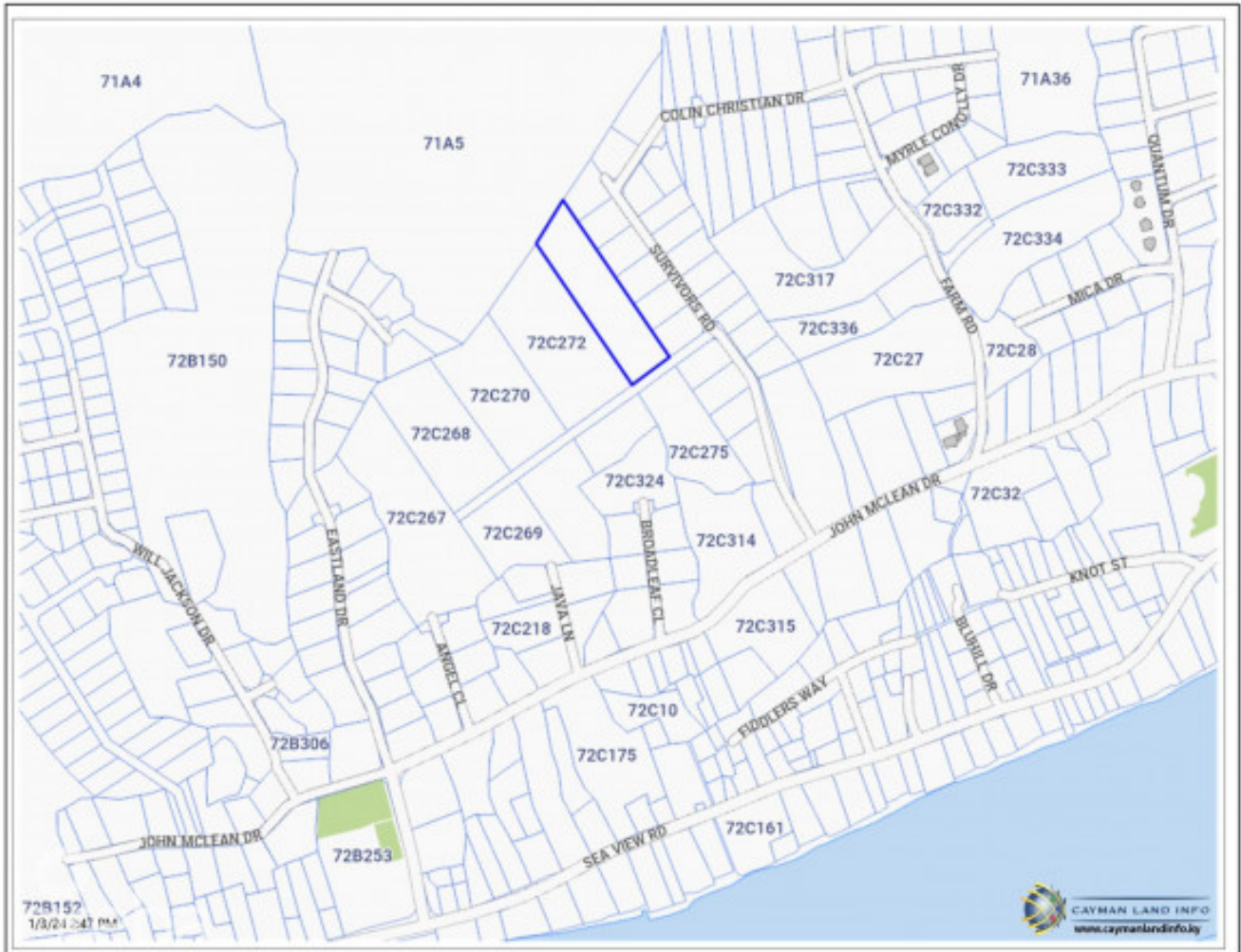

Sandra Simmons-Francis
sandra@regalrealty.ky

Residential developable land north of John McLean Drive generally 5ft above sea level. Suitable for subdivision into seven house lots or 36 apartments

Essential Information

Type
Land (For Sale)

Status
Current

MLS
417049

Listing Type
Med density residential

Key Details

Width
140

Depth
540

Block & Parcel
72C,274

Old Price
0.00

Acreage
1.8100

Additional Fields

Block
72C

Parcel
274

Views
Garden View

Zoning
**Medium Density
Residential**

Road Frontage
140

Soil
Rock